

**WIRING LEGEND:**

- S SWITCH
- (NONE) SINGLE POLE TOGGLE SWITCH
- 2 TWO POLE TOGGLE SWITCH
- 3 THREE WAY TOGGLE SWITCH
- 4 FOUR WAY TOGGLE SWITCH
- D DIMMER SWITCH
- O OCCUPANCY SENSOR SWITCH
- V VACANCY SENSOR SWITCH
- SV COMBINATION DIMMER/VACANCY SENSOR SWITCH
- 3D THREE WAY DIMMER SWITCH
- S<sub>0</sub> LOWER CASE LETTER DESIGNATES SWITCH LEG
- ⊕ SINGLE RECEPTACLE
- ⊕ DUPLEX RECEPTACLE
- ⊕ QUADRUPLEX RECEPTACLE
- ⊕ SPECIAL RECEPTACLE
- GF GROUND FAULT CIRCUIT INTERRUPTER
- C COUNTER HEIGHT
- TR TAMPER RESISTANT, UL LISTED
- WP WEATHERPROOF
- HWP1-4 BRANCH CIRCUIT HOME RUN WITH PANEL NAME AND CIRCUIT NUMBER. QUANTITY OF ARROWHEADS DENOTES QUANTITY OF BRANCH CIRCUITS.
- GF BKR. GFI TYPE BREAKER
- A-F. BKR. ARC FAULT BREAKER
- BRANCH CIRCUIT WIRING. PROVIDE QUANTITIES OF CONDUCTORS REQUIRED FOR CIRCUITING AND SWITCHING AS INDICATED
- POWER LEG ONLY (NO SWITCH LEG BETWEEN ROOMS)

**COMMUNICATIONS LEGEND:**

- DATA DROP
- (NONE) STANDARD MODULAR JACK FOR TELEPHONE
- W WALL MOUNTED TELEPHONE MODULAR JACK
- P PUBLIC TELEPHONE MODULAR JACK
- C COUNTER HEIGHT MODULAR JACK
- CEILING MOUNTED WIRELESS ACCESS POINT
- DATA RACK
- SPEAKER (PUBLIC ADDRESS)
- (NONE) CEILING MOUNTED
- W WALL MOUNTED
- LIGHTING FIXTURE (SEE LUMINAIRE SCHEDULE FOR LETTER DESIGNATION AND DESCRIPTION OF FIXTURES)
- EMERGENCY AND/OR NIGHT LIGHT LIGHTING FIXTURE
- EXIT LIGHTING FIXTURE UNIVERSAL MOUNT, SINGLE/DOUBLE FACE (WHERE USED, ARROW INDICATES CHEVRON DIRECTION)
- BATTERY POWERED EMERGENCY LIGHT
- OCCUPANCY SENSOR - CEILING MOUNTED
- VACANCY SENSOR - CEILING MOUNTED

**FIRE/LIFE SAFETY LEGEND:**

- FIRE ALARM PULL STATION
- FIRE ALARM HORN AND STROBE COMBINATION
- FIRE ALARM SPEAKER AND STROBE COMBINATION
- FIRE ALARM STROBE
- FIRE ALARM BELL
- SMOKE DETECTOR
- CARBON MONOXIDE DETECTOR
- HEAT DETECTOR
- FLOW SWITCH
- TAMPER SWITCH

**PANEL LEGEND:**

- EXISTING ELECTRICAL PANEL
- ELECTRICAL SYSTEMS PANEL
- FACP FIRE ALARM CONTROL PANEL
- PA PUBLIC ADDRESS CONTROL PANEL
- FAAP FIRE ALARM ANNUNCIATOR PANEL

**LIGHT FIXTURE LEGEND:**

- LIGHTING FIXTURE (SEE LUMINAIRE SCHEDULE FOR LETTER DESIGNATION AND DESCRIPTION OF FIXTURES)
- EMERGENCY AND/OR NIGHT LIGHT LIGHTING FIXTURE
- EXIT LIGHTING FIXTURE UNIVERSAL MOUNT, SINGLE/DOUBLE FACE (WHERE USED, ARROW INDICATES CHEVRON DIRECTION)
- BATTERY POWERED EMERGENCY LIGHT
- OCCUPANCY SENSOR - CEILING MOUNTED
- VACANCY SENSOR - CEILING MOUNTED

**DEMOLITION KEY NOTES**

- (D1) EXISTING LIGHT FIXTURE TO BE RELOCATED. DISCONNECT AND SALVAGE FIXTURE FOR RE-INSTALLATION. EXISTING CIRCUITING TO REMAIN AND BE EXTENDED TO NEW LOCATION.
- (D2) DISCONNECT AND REMOVE EXISTING LIGHT FIXTURES IN SPACE. EXISTING LIGHTING CIRCUIT TO REMAIN TO SERVE NEW FIXTURE LAYOUT.

**NEW WORK KEY NOTES**

- (N1) RE-INSTALL SALVAGED FIXTURE AND CONNECT TO NEW SWITCH IN SPACE. REWORK/EXTEND EXISTING BRANCH CIRCUIT TO NEW FIXTURE LOCATION AS REQUIRED.
- (N2) CONNECT NEW RECEPTACLES TO EXISTING RECEPTACLE CIRCUIT AS INDICATED WITH (2) #12, #12G IN 3/4" CONDUIT.
- (N3) PROVIDE NEW 120V CARBON MONOXIDE DETECTOR AND CONNECT TO EXISTING CO DETECTOR CIRCUIT #31 IN PANEL 'PP-B' WITH (2) #12, #12G IN 3/4" CONDUIT.
- (N4) CONNECT NEW LIGHT FIXTURES IN SPACE TO EXISTING LIGHTING CIRCUIT THAT SERVED PREVIOUS FIXTURE LAYOUT. REWORK/EXTEND WIRING AND CONDUIT AS REQUIRED.
- (N5) CONNECT EXISTING LIGHT FIXTURES TO NEW LIGHTING CIRCUIT AS INDICATED WITH (2) #12, #12G IN 3/4" CONDUIT.
- (N6) CONNECT TO NEAREST RECEPTACLE CIRCUIT CURRENTLY SERVING ROOM WITH (2) #12, #12G IN 3/4" C.

**NEW WORK GENERAL NOTES**

- A. (E)-EXISTING TO REMAIN. ANY DEVICE, AS WELL AS ITS ASSOCIATED CIRCUITING AND CONDUIT, LABELED 'E' SHALL REMAIN, UNLESS OTHERWISE NOTED.
- B. FOR ALL WALL MOUNT VOICE/DATA DROPS SHOWN, PROVIDE FLUSH MOUNT 2-GANG BOX WITH SINGLE GANG DEVICE RING. PROVIDE (2) CATEGORY 6 UTP CABLES IN 3/4" CONDUIT ABOVE FINISHED CEILING SPACE TO DATA RACK ON FIRST FLOOR. PROVIDE ASSOCIATED 2-PORT FACEPLATE, BRACKETS, (2) RJ45 JACKS, ETC. AT DROP LOCATION.
- C. NEW FIRE ALARM DEVICES SHOWN SHALL BE COMPATIBLE WITH AND CONNECTED TO FIRE ALARM CONTROL PANEL SYSTEM SERVING BUILDING. CONTRACTOR SHALL BE RESPONSIBLE FOR ALL ASSOCIATED TERMINATIONS, PROGRAMMING, TESTING. ADDITIONAL NOTIFICATION APPLIANCE CIRCUIT (NAC) PANELS, 120V POWER TO ALL NAC PANELS, ETC. FOR A COMPLETE OPERATIONAL SYSTEM.
- D. ALL NEW RECEPTACLES SHOWN SHALL BE TAMPER RESISTANT.
- E. ALL NEW CABLING ABOVE CEILING SHALL BE PLENUM RATED.
- F. REFER TO LUMINAIRE SCHEDULE ON THIS SHEET FOR FIXTURE TYPE MARK DESCRIPTIONS, NOTES, AND SPECIFICATIONS.
- G. CONNECT NEW EXIT SIGNS AND WALL MOUNT TYPE 'EM' FIXTURES TOGETHER WITH (2) #10, #10G IN 3/4" CONDUIT TO EXISTING DEDICATED CIRCUIT #25 IN PANEL 'PP-B'. FIXTURES SHALL NOT BE CONNECTED TO ANY LOCAL LIGHTING SWITCHING/CONTROLS IN SPACE.
- H. CONNECT NEW 120V DEVICES/FIXTURES TO A 20/1 CIRCUIT BREAKER IN PANEL 'PP-B' WITH (2) #12, #12G IN 3/4" CONDUIT, UNLESS NOTED OTHERWISE.
- I. NEW CEILING SPEAKERS SHALL BE 8" FLUSH MOUNT ROUND SPEAKERS THAT ARE COMPATIBLE WITH AND CONNECTED TO EXISTING BUILDING PUBLIC ADDRESS SYSTEM. EXISTING PUBLIC ADDRESS SYSTEM AUDIO AMPLIFIER IS BOGEN CLASSIC SERIES MODEL C-35 AND IS LOCATED IN FIRST FLOOR MECH ROOM 32. PROVIDE ALL CABLING, TERMINATIONS AND FINAL TESTING IS REQUIRED.

**GENERAL DEMOLITION NOTES**

- A. ALL ITEMS SHOWN ARE TO BE REMOVED UNLESS LABELED AS (E) EXISTING. REMOVAL OF DEVICE INCLUDES ITS ASSOCIATED CABLING/BRANCH CIRCUIT WIRING, AND RACEWAY.
- B. ANY EXISTING DEVICE TO REMAIN, LABELED AS (E) SHALL REMAIN IN PLACE AS WELL AS ITS ASSOCIATED CIRCUITING AND CONDUIT, UNLESS OTHERWISE NOTED.
- C. THE CONTRACTOR SHALL REMOVE THE EXISTING ELECTRIC IN AREAS OF NEW RENOVATIONS TO ACCOMMODATE NEW CONSTRUCTION. REROUTING OF EXISTING MAY BE REQUIRED AT NEW OPENINGS IN EXISTING CONSTRUCTION OR INTERFERENCE WITH OTHER NEW WORK AS NOTED IN THE FOLLOWING NOTES.
- D. DRAWINGS INDICATE SPECIFIC ITEMS TO BE REMOVED AND/OR RELOCATED IN ORDER TO INDICATE GENERAL SCOPE. ADDITIONAL ITEMS NOT INDICATED, BUT NECESSARY FOR PROJECT RENOVATIONS, SHALL BE REMOVED, RELOCATED AND/OR REROUTED.
- E. WHERE DEVICES, FIXTURES, ETC. ARE INDICATED TO BE REMOVED, THEY AND THEIR RELATED WIRING/CONDUIT SHALL BE REMOVED BACK TO THE SOURCE PANELBOARD UNLESS OTHERWISE NOTED. ON CIRCUITS WHERE OTHER DEVICES, FIXTURES, ETC. ARE FOUND THAT MUST REMAIN, MAINTAIN CIRCUIT CONTINUITY BY PROVIDING ADDITIONAL WIRING, TO FEED THROUGH TO THESE REMAINING ITEMS. RELOCATE ANY CIRCUITS THAT REMAIN, TO AVOID CONFLICT WITH NEW CONSTRUCTION AS REQUIRED, PROPERLY TERMINATE ALL WIRING.
- F. COORDINATE DEMOLITION OF EQUIPMENT, DEVICES, ETC. WITH OTHER DISCIPLINES AS APPLICABLE. REFER TO ARCHITECTURAL DEMOLITION DRAWINGS AND NOTES FOR COORDINATION.
- G. DRAWINGS ARE GRAPHICAL REPRESENTATIONS OF APPROXIMATE EQUIPMENT AND DEVICE LOCATIONS. CONTRACTOR SHALL VISIT THE SITE TO DETERMINE THE EXACT EXTENT OF ELECTRICAL WORK REQUIRED TO COMPLETE THE PROJECT. EXISTING CONDITIONS ARE TAKEN FROM FIELD OBSERVATION AND EXISTING BUILDING DOCUMENTS. OTHER ELECTRICAL ITEMS MAY EXIST FOR WHICH THE CONTRACTOR IS RESPONSIBLE.
- H. CONTRACTOR SHALL PROPERLY DISPOSE OF ALL ITEMS, EQUIPMENT, PANELS, LIGHT FIXTURES, ETC. BEING REMOVED AS PART OF THIS PROJECT. THE OWNER SHALL HAVE THE RIGHT OF RETAINING ANY ITEMS BEING REMOVED.
- I. CONTRACTOR SHALL PROVIDE NEW COVERPLATES ON ALL BOXES OF UNUSED AND/OR REMOVED FLUSH MOUNT DEVICES UPON COMPLETION OF PROJECT.
- J. FIREPROOFING AND/OR FIRE STOP MATERIALS REMOVED FROM FIRE RATED WALLS AND CEILING AS A RESULT OF DEMOLITION SHALL BE RE-INSTALLED USING AN APPROVED METHOD AS DESCRIBED IN ASSOCIATED PROJECT SPECIFICATIONS.

LUMINAIRE SCHEDULE									
TYPE	DESCRIPTION	MANUFACTURER	MODEL	VOLTS	LOAD	TYPE/CCT	LUMENS	MOUNTING	COMMENTS
EM	WALL MOUNT LED EMERGENCY LIGHT WITH BATTERY BACK-UP	COMPASS	CU25Q2D	120 V	0 VA		0	WALL - SURFACE	
L1	2X2 RECESSED LED TROFFER W/ 0-10V DIMMING	COLUMBIA	LCAT22-3SHLC-EDU	120 V	3 VA	LED	1000	GRID-RECESSED	
L1/E	2X2 RECESSED LED TROFFER W/ 0-10V DIMMING WITH EMERGENCY BATTERY BACK-UP	COLUMBIA	LCAT22-3SHLG-EDU-ELL14	120 V	32 VA	3500K LED	3707	GRID-RECESSED	
L2	1X4 LINEAR WRAPAROUND LED W/ EMERGENCY BATTERY BACK-UP	COLUMBIA	LAW4-33LW-EDU-ELL14	120 V	24 VA	3500K LED	2644	CEILING-SURFACE	1
L3	1X4 BACK-LIT TROFFER WITH 0-10V DIMMING	COLUMBIA	CBT14-L335-CBTSMK14	120 V	31 VA	3500K LED	3502	CEILING-RECESSED	2
X1	LED EXIT SIGN WITH RED LETTERS AND BATTERY BACK-UP	DUAL-LITE	EVE-U-R-W-E-1	120 V	3 VA	LED	200	CEILING	1
X2	DOUBLE SIDED LED EXIT SIGN WITH RED LETTERS AND BATTERY BACK-UP	DUAL-LITE	EVE-U-R-W-E-1	120 V	3 VA	LED	200	CEILING	1

- COMMENTS:**
1. FIXTURE SHALL BE CAPABLE OF PROVIDING A MINIMUM OF 90 MINUTES OF ILLUMINATION DURING POWER LOSS.
  2. FIXTURE SHALL CONTAIN 1X4 SURFACE MOUNT KIT

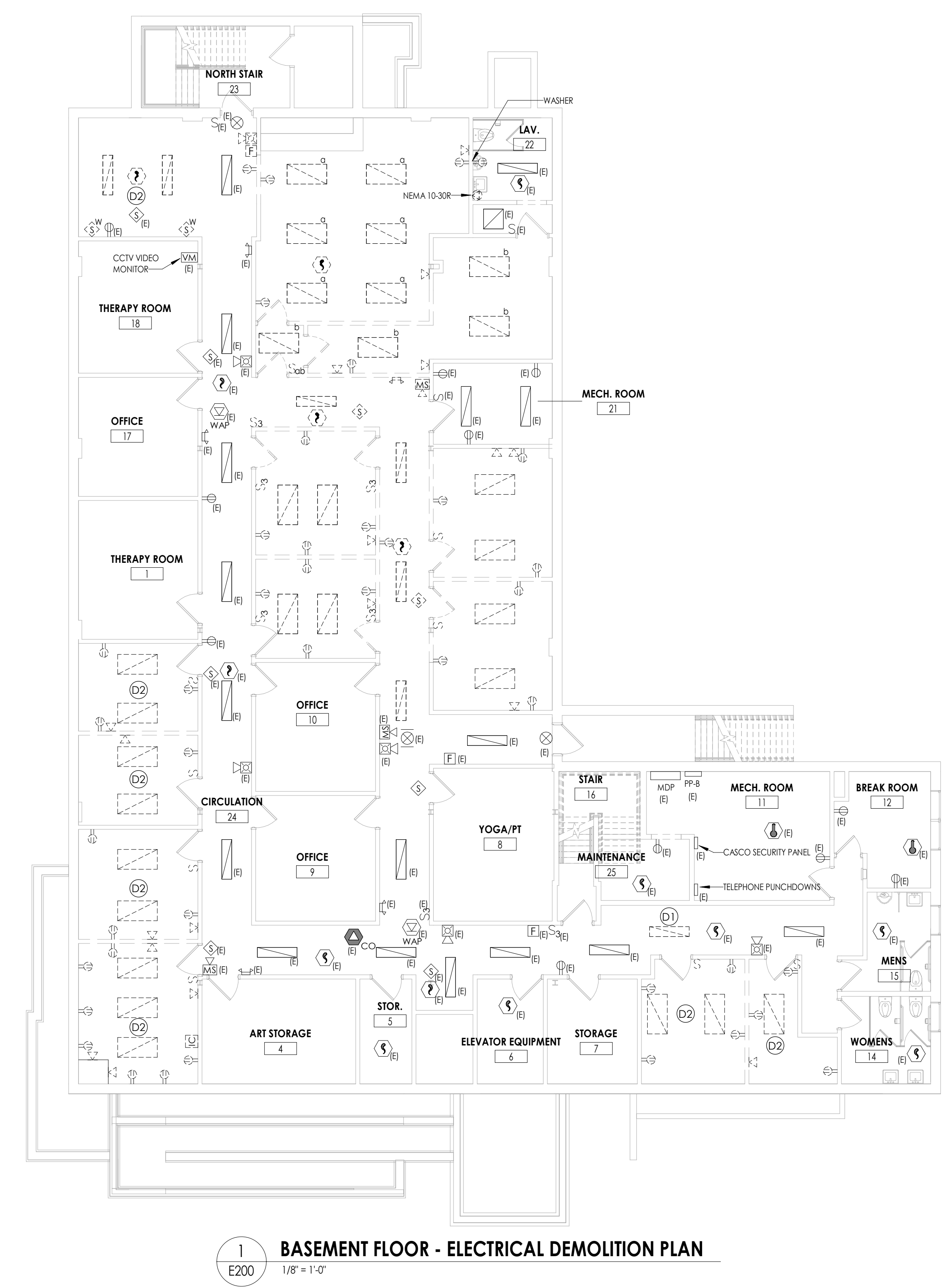
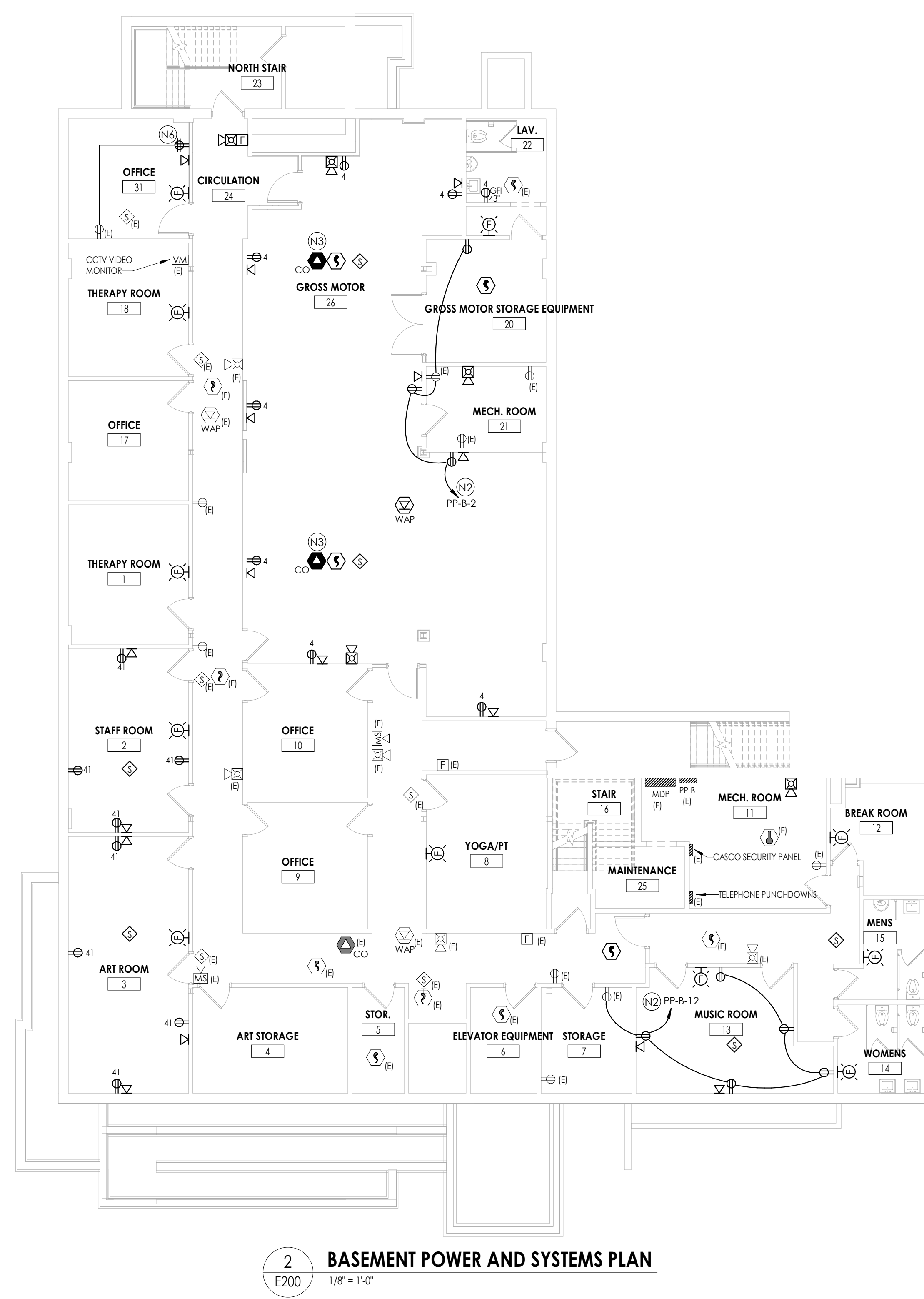
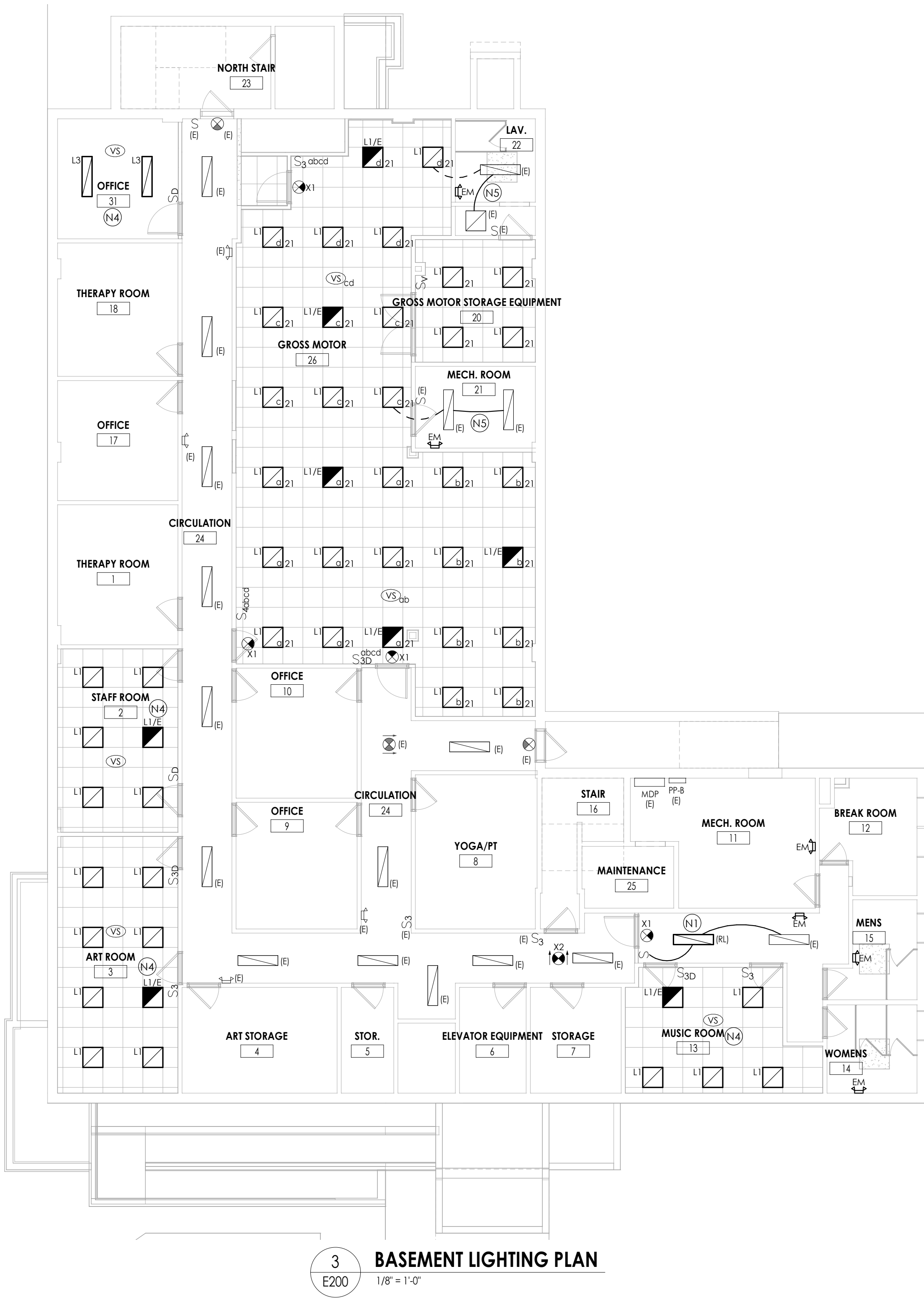

NO.	DATE	CON. #	BY	REVISION/SCHEDULE	DESCRIPTION

**FOR REVIEW ONLY  
NOT FOR PERMIT OR  
CONSTRUCTION**

OLV Human Services  
650 RIDGE RD - BUILDING IMPROVEMENTS  
BAKER ACADEMY  
650 RIDGE ROAD, LACKAWANNA, NY 14218

DATE	DRAWN	CHECKED
05/14/21	MN	ARM

SCALE: As indicated  
SHEET TITLE: BASEMENT ELECTRICAL PLANS

PROJECT NUMBER 13321.00
<b>OLV E200</b>
DRAWING NUMBER