





**CLARIFICATION:**

1. GENERAL CONSTRUCTION

- A. The elevator specified and to be installed is a 3,500 lb. capacity, front side opening with 42" wide doors per floor. The elevator is required by code to accommodate a 24" x 84" stretcher.
- B. An emergency key box is to be provided and installed on the exterior façade at the first floor lobby entrance. See attached construction sketch SK-A03 for more information.

2. PLUMBING

- A. The fire department connection to be a Siamese with 2-1/2" national standard thread (NST) inlets.
- B. Plumbing drawings do not detail a floor drain in the first floor electrical and trash rooms, however under slab piping was previously installed for these locations and will require a floor drain. Provide two (2) floor drains (FD-1) as specified on plumbing fixture connection schedule on plumbing drawings.

3. FIRE PROTECTION

- A. For clarification purposes, the bid documents detail an NFPA 13 sprinkler system for protection to reduce fire ratings of certain assemblies.
- B. Per the fire code review from the Village of Williamsville fire inspector, additional bathrooms that do not meet *Chapter 9, section 903.3.1.1.2* of the *2015 IBC* require a sprinkler. The bathrooms are as follows: 202N/302N, 203H/303H, and 2040/3040.

**END OF BID ADDENDUM No.1**

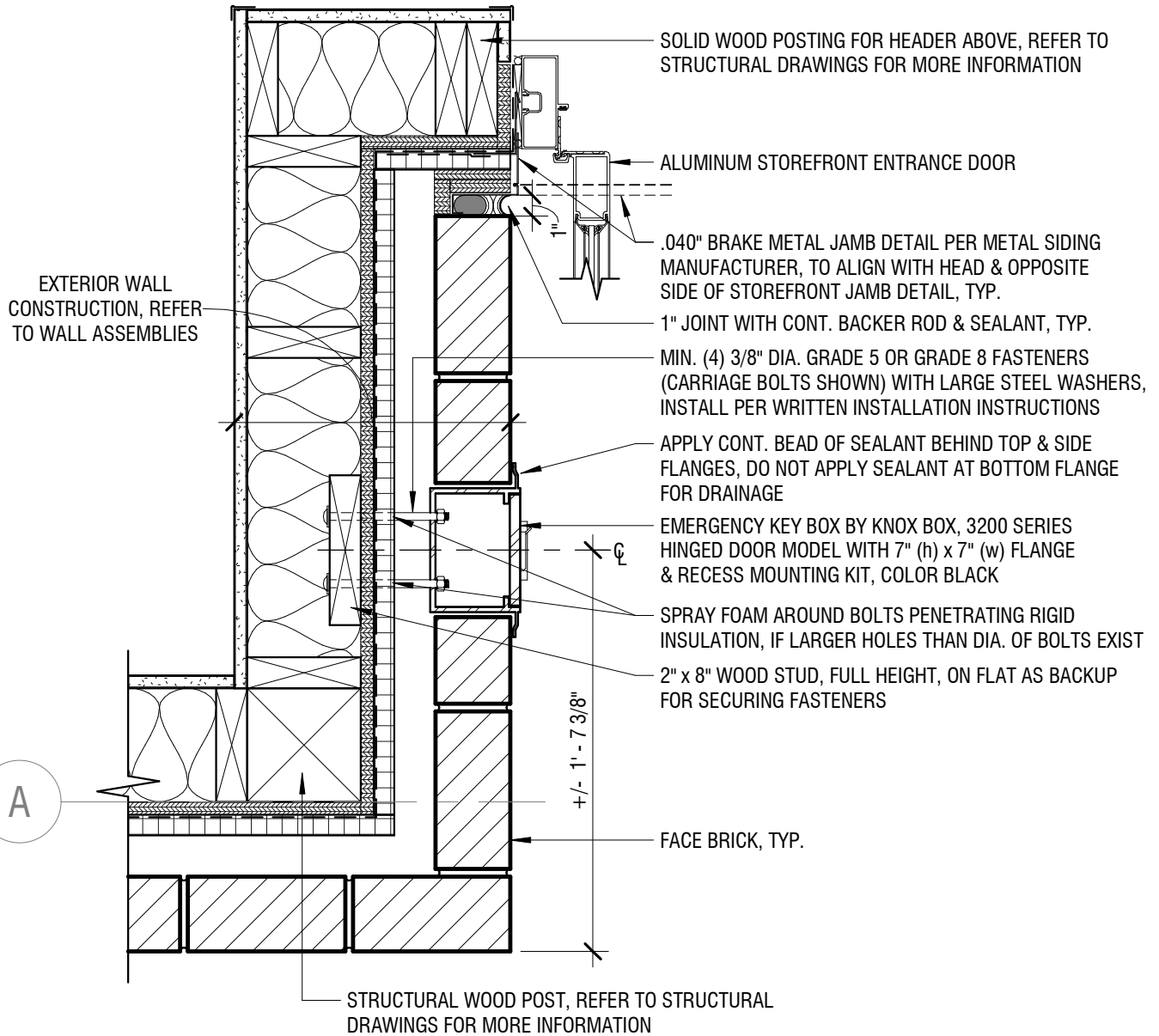

1 PLAN DETAIL - EMERGENCY KEY BOX  
 SK-A03 SCALE: 1 1/2" = 1'-0"

**NOTES:**

1. REFER TO THE KNOX COMPANY GENERAL MOUNTING INSTRUCTIONS FOR ALL OTHER MOUNTING REQUIREMENTS NOT DEPICTED IN THIS SKETCH.
2. RECOMMENDED MOUNTING HEIGHT ABOVE FINISHED FLOOR/GRADE TO BE 6'-0" AS PER THE KNOX COMPANY.

**NEW PLAN DETAIL**



300 Pearl Street, Suite 130  
 Buffalo, NY 14202  
 716-551-6281  
 labellapc.com

It is a violation of New York Education Law Article 145 Sec.7209, for any person, unless acting under the direction of a licensed architect, professional engineer, or land surveyor, to alter an item in any way. If an item bearing the seal of an architect, engineer, or land surveyor is altered, the altering architect, engineer, or land surveyor shall affix to the item their seal and notation "altered by" followed by their signature and date of such alteration, and a specific description of the alteration.

DRAWING NAME:  
**EMERGENCY KEY BOX**

PROJECT NAME:  
**THE WILLIAMS**  
 20 SOUTH LONG STREET  
 WILLIAMSVILLE, NY 14221

REVISION:

DRAWN BY: JMR	DATE: 5.25.2021	PROJECT NO.: 2202196
------------------	--------------------	-------------------------

DETAIL NO./REVISED SHEET:	SHEET NUMBER: <b>SK-A03</b>
---------------------------	--------------------------------