

All rights reserved. Reuse of these documents without the expressed written permission of Carmina Wood Morris DPC is prohibited. WARNING: It is violation of article 146 sections 7209N and 7301 of the New York State Education Law for any person, unless acting under the direction of a registered architect, licensed engineer or land surveyor to alter this drawing. If altered such R.A., P.E. or L.L.S. shall affix his or her seal, signature, the date, the notation "altered by" and a specific description of the alteration.

© Carmina Wood Morris DPC

NYS DEPT. AUDIT & CONTROL NOW  
OR FORMERLY SBL # 71.13-1-6

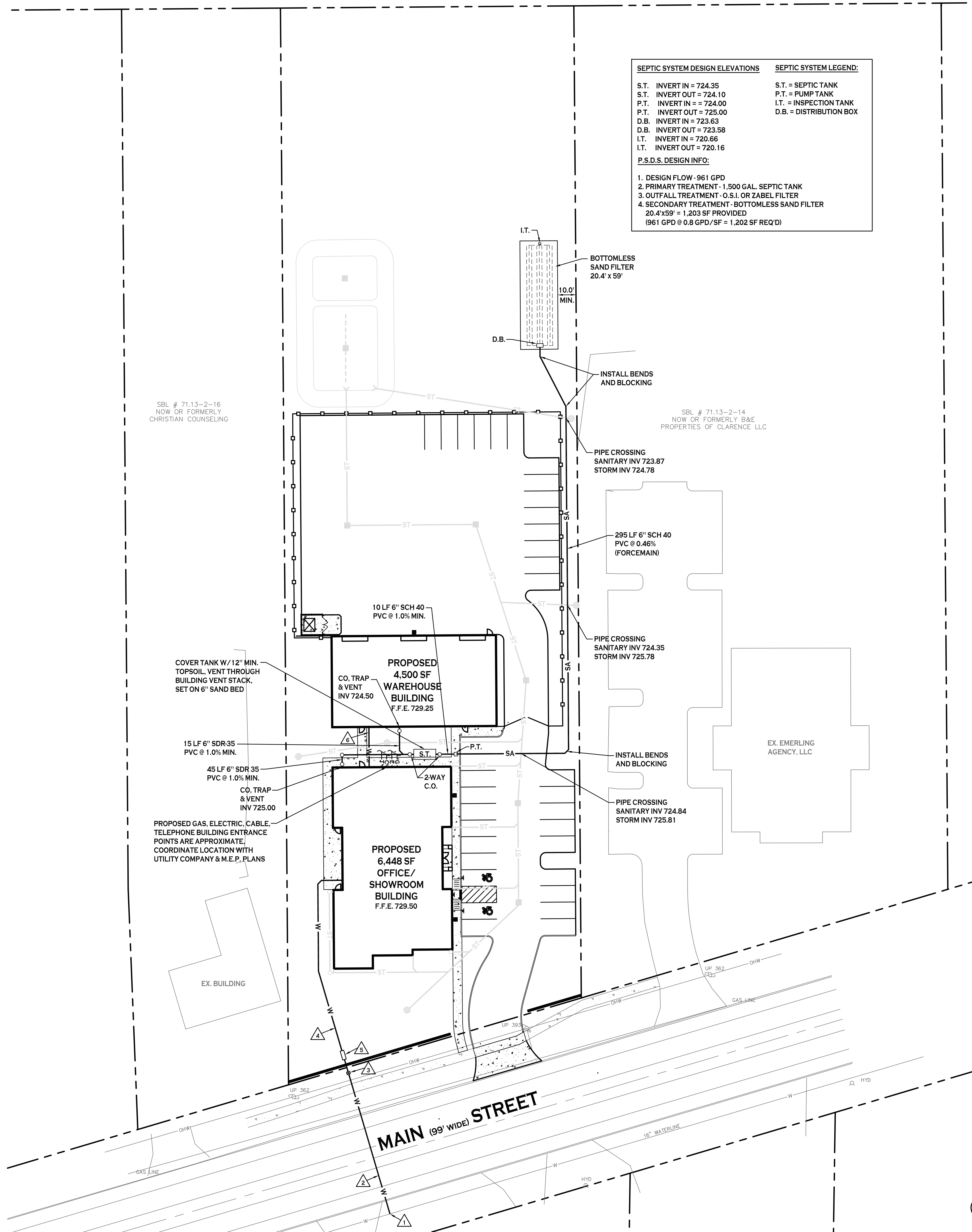

SEPTIC SYSTEM DESIGN ELEVATIONS	SEPTIC SYSTEM LEGEND:
S.T. INVERT IN = 724.35	S.T. = SEPTIC TANK
S.T. INVERT OUT = 724.10	P.T. = PUMP TANK
P.T. INVERT IN = 724.00	I.T. = INSPECTION TANK
P.T. INVERT OUT = 725.00	D.B. = DISTRIBUTION BOX
D.B. INVERT IN = 723.63	
D.B. INVERT OUT = 723.58	
I.T. INVERT IN = 720.66	
I.T. INVERT OUT = 720.16	
<b>P.S.D.S. DESIGN INFO:</b>	
1. DESIGN FLOW - 961 GPD	
2. PRIMARY TREATMENT - 1,500 GAL. SEPTIC TANK	
3. OUTFALL TREATMENT - O.S.I. OR ZABEL FILTER	
4. SECONDARY TREATMENT - BOTTOMLESS SAND FILTER	
20.4'x59' = 1,203 SF PROVIDED	
(961 GPD @ 0.8 GPD/SF = 1,202 SF REQ'D)	

- UTILITY NOTES:**
- EXISTING WATER, GAS, AND ELECTRIC SHOWN ARE APPROXIMATE. CONTRACTOR TO FIELD VERIFY LOCATION/SIZE/CONDITION BEFORE CONSTRUCTION.
  - SELECT BACKFILL IS REQUIRED FOR ALL UTILITIES (GAS, WATER, STORM, SANITARY) THAT CROSS THROUGH PAVEMENT AREAS.
  - IF NECESSARY, PROVIDE FITTINGS AND BLOCKING AS NECESSARY AT ALL BENDS IN WATER LINES.
  - A MINIMUM OF 10 FEET HORIZONTAL AND 18 INCHES OF VERTICAL SEPARATION MUST BE MAINTAINED BETWEEN ALL SANITARY SEWER AND WATER SERVICES.
  - ERIE COUNTY WATER AUTHORITY IS TO BE NOTIFIED A MINIMUM OF 48 HOURS PRIOR TO STARTING THE CONNECTION FOR THE NEW WATER SERVICE.
  - ALL SANITARY SEWER CONSTRUCTION SHALL ADHERE TO ERIE COUNTY DIVISION OF SEWERAGE MANAGEMENT SPECIFICATIONS AND DETAILS, AND ERIE COUNTY DEPARTMENT OF HEALTH RULES AND REGULATIONS.
  - ALL OTHER REQUIRED PERMITS BY THE STATE OF NEW YORK, ERIE COUNTY, OR TOWN OF CLARENCE ARE THE RESPONSIBILITY OF THE CONTRACTOR.

PROPOSED STORM/UTILITY LEGEND	
PROPOSED WATER LINE	— W —
PROPOSED SANITARY SEWER	— SA —
PROPOSED UTILITY CONNECTIONS (GAS, ELEC., CABLE, TEL., ETC.)	⊕
PROPOSED GATE VALVE	⊗
PROPOSED CLEANOUT	○

- WATER NOTE LEGEND**
- △ 2" CORP. STOP (BY ECWA)
  - △ 2" TYPE 'K' COPPER DOMESTIC SERVICE (BY ECWA)
  - △ 2" CURB STOP, VALVE & BOX
  - △ 2" POLYETHYLENE DOMESTIC SERVICE
  - △ METER AND RPZ HOT BOX ENCLOSURE SEE DETAIL ON DWG C-401
  - △ 1" TYPE 'K' COPPER DOMESTIC SERVICE

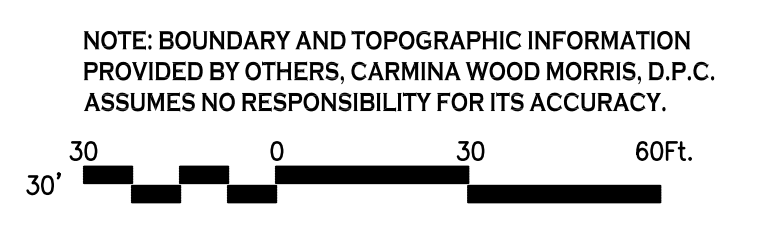

**REVISIONS:**

No.	Description	Date
1	Rev. septic tank location	2/18/20

**PROJECT NAME:**  
New Construction  
**Office & Warehouse Buildings**  
9074 Main Street  
Clarence, New York

Date: 8/20/19  
Drawn by: P. Sheedy  
Scale: As Noted

**DRAWING NAME:**  
Utility Plan

**DRAWING NO.:**  
**C-400**  
Project no.: 19.004

**UTILITY PLAN**  
SCALE: 1"=30'